

EAST MAIN STREET RETAIL OR OFFICE

403 EAST MAIN STREET
SALISBURY, MARYLAND 21804

FOR LEASE

\$12.50 psf



Building for lease - Downtown location with great visibility and traffic counts. Walking distance to downtown Salisbury. 4,800 Sq. Ft. total - can be divided for 2 tenants or use half and sublease the rest. Building layout great for retail and office users. Large picture windows, plenty of free parking, drive-in access door, convenient to Route 13 and Route 50.

For information, contact:

SCHNEIDER COMMERCIAL



Joe Schneider
715-A Eastern Shore Drive
Salisbury, MD 21804
(443) 880-4100
joe@joeschneider.com

www.joeschneider.com

©2007, CB Richard Ellis, Inc. We obtained the information above from sources we believe to be reliable. However, we have not verified its accuracy and make no guarantee, warranty or representation about it. It is submitted subject to the possibility of errors, omissions, change of price, rental or other conditions, prior sale, lease or financing, or withdrawal without notice. We include projections, opinions, assumptions or estimates for example only, and they may not represent current or future performance of the property. You and your tax and legal advisors should conduct your own investigation of the property and transaction.

CBRE
CB RICHARD ELLIS

EAST MAIN STREET RETAIL OR OFFICE

403 EAST MAIN STREET
SALISBURY, MARYLAND 21804

FOR LEASE

\$12.50 psf

FLOOR PLAN

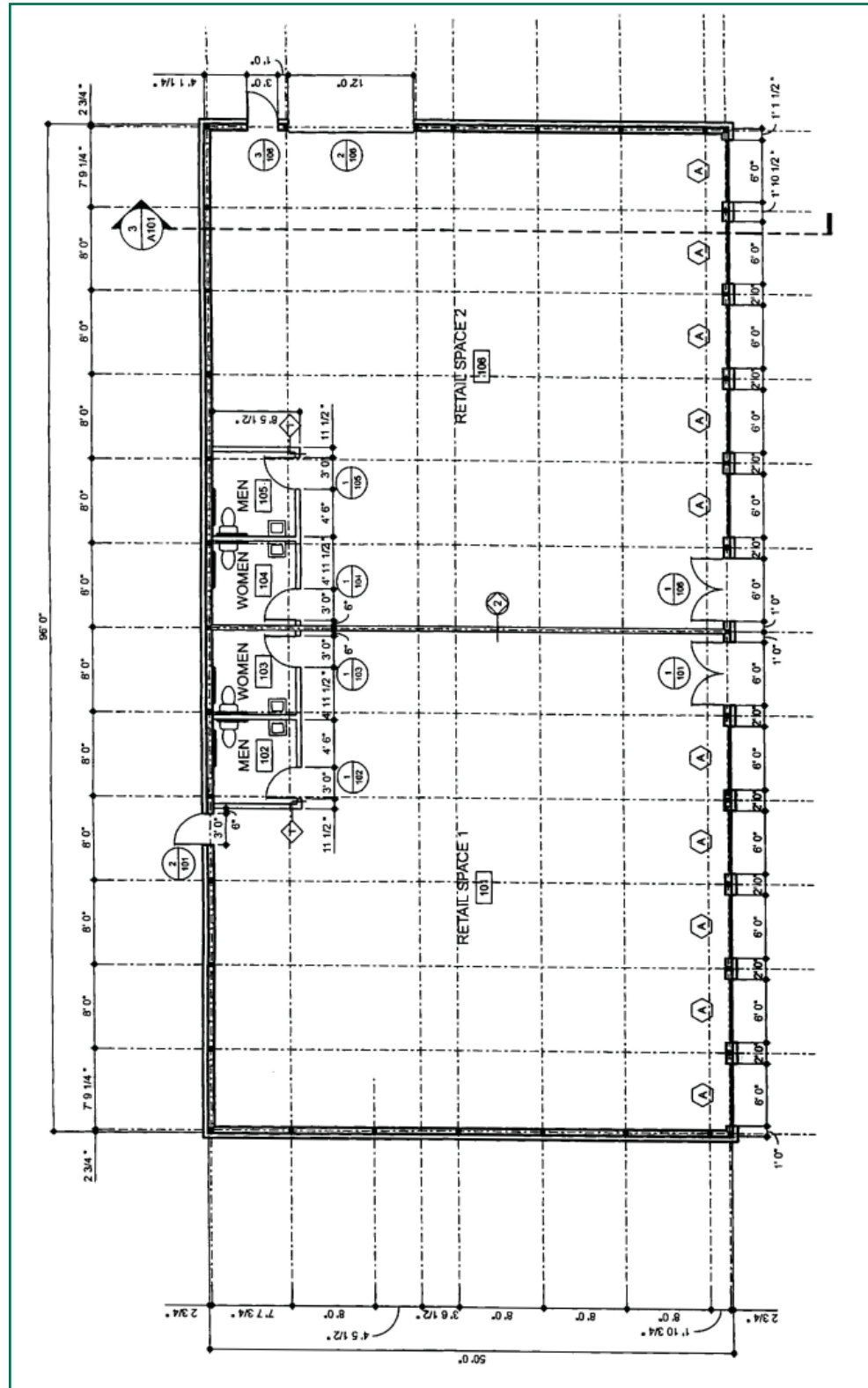

For information, contact:

SCHNEIDER COMMERCIAL



Joe Schneider
715-A Eastern Shore Drive
Salisbury, MD 21804
(443) 880-4100
joe@joeschneider.com

www.joeschneider.com

©2007, CB Richard Ellis, Inc. We obtained the information above from sources we believe to be reliable. However, we have not verified its accuracy and make no guarantee, warranty or representation about it. It is submitted subject to the possibility of errors, omissions, change of price, rental or other conditions, prior sale, lease or financing, or withdrawal without notice. We include projections, opinions, assumptions or estimates for example only, and they may not represent current or future performance of the property. You and your tax and legal advisors should conduct your own investigation of the property and transaction.

CBRE
CB RICHARD ELLIS